

Terminal Box Type Ex-3



Junction box for EX-areas

The junction box Ex-3 in conventional design is suitable for use in potentially explosive atmosphere in accordance with Ex-guidelines 94/9/CE (ATEX 95). Moreover, the unit Ex-3 covers a significantly wide range of ambient temperatures as shown on the data sheet. The junction box can be wall-mounted and is also available with stands for mounting on pipes.

Advantages:

- Covers a wide range of temperatures
- Suited for mounting on pipes

Applications:

- Hazardous areas
- Chemical & petrochemical industries
- Power stations
- Industrial plants with a need for frost protection or temperature maintenance

Technical data:

Classification II 2G Ex e IIC T6...T4 Gb
II 2D Ex tb IIIC T80°C Db
 CertificateEPS13ATEX 1506X, IECExEPS 13.0002
 Standards IEC 60079-0:2009, EN 60079-7:2007,
EN 60079-31:2009
 Ambient temperature.....-40°C up to +50°C (T6, T85°C)
-40°C up to +55°C (T5, T100°C)
-40°C up to +60°C (T4, T100°C)
 Nominal current..... see type plate, max 36A

Nominal voltage See type plate, max 550V
 Terminalsmin. 0,5mm², max 10mm² (except Ex-3.8)
 Enclosure.....Polyester
 Dimensions (approx).....lxhxd: 122 x 120 x 90mm
 Impact resistance..... 7 joule
 Cable glands polyamide
 IP rating IP65/66 depending on design
 Weight approx. 1 kg
 Type of mounting..... wall mounting

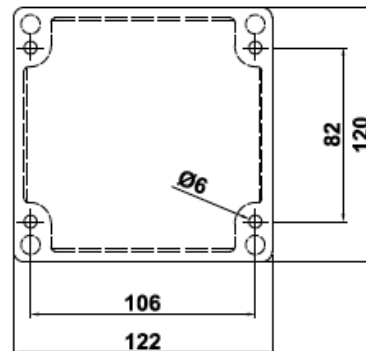

The Ex-3 unit fitted with mounting stand is also suited for mounting on pipes. The mounting stand is 100mm high.